

The thickness of the wood can be what you want. I used $\frac{3}{4}$ " thick walnut.
 The length of the middle stretchers is contingent on the size of your pot.
 Measure your pots radius and add one half inch. Add half lap joint to center.

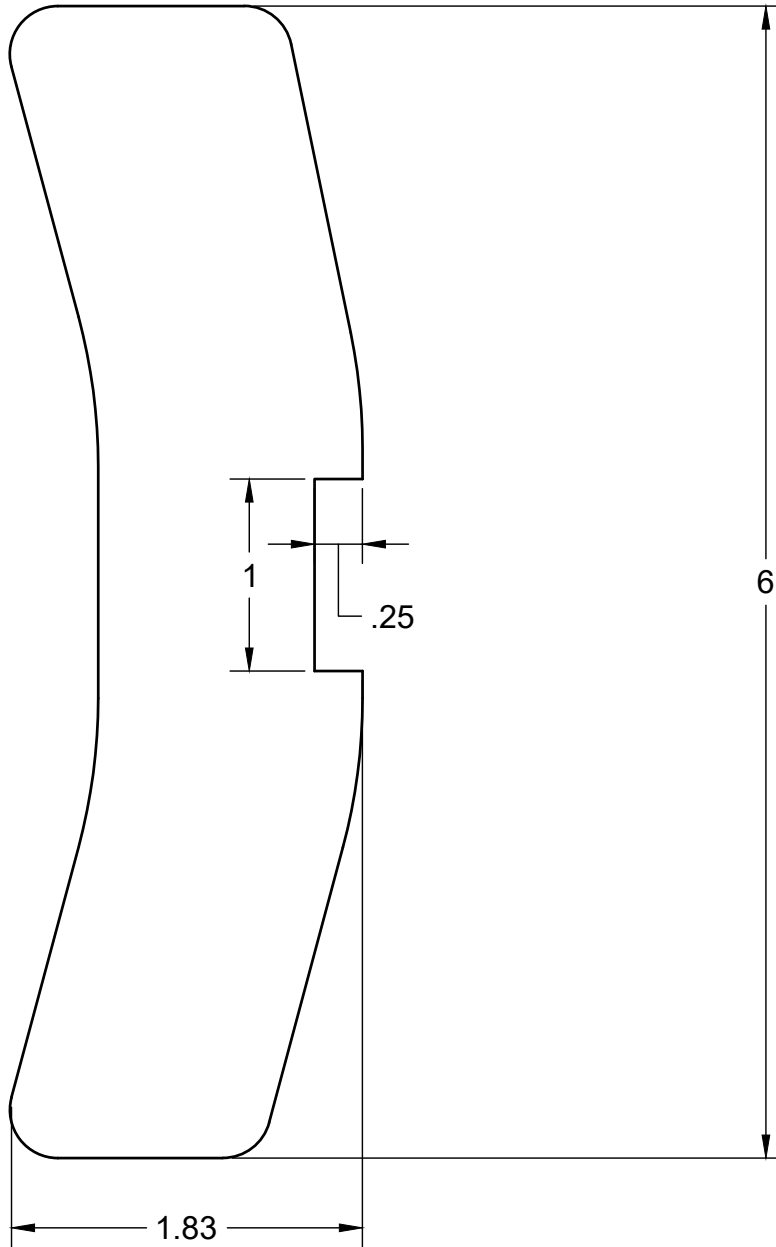

PROJECT
Plant Stand

TITLE
Plant Stand

APPROVED	SIZE	CODE	DWG NO	REV
CHECKED	A			
DRAWN John Evans 1/16/2021	SCALE 1:1	WEIGHT	SHEET 1/1	